

Materials Supplied:

- 1x L-shaped bracket (fitted to the antenna)
- 2x M6 wing nuts
- 2x spring washers
- 2x flat washers
- 1x clamp
- 1x M6 U-bolt
- 1x M20 nut

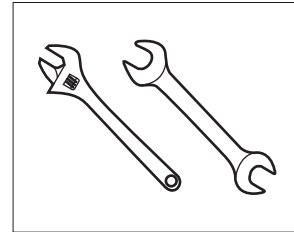

Required Tools: 24mm spanner or adjustable wrench.

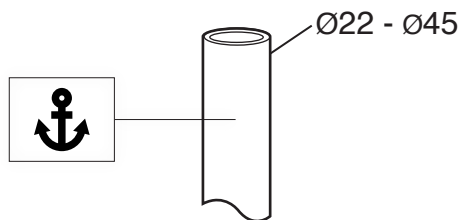

1. Preparing the Pole

Pole Requirements: Ensure the pole is sturdy and securely anchored. The diameter should be compatible with the supplied clamp and U-bolt (between 22 - 45mm).

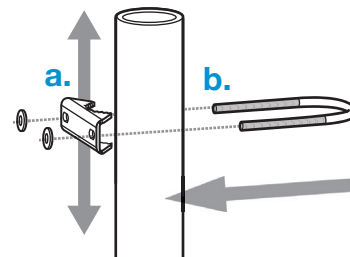

2. Attaching the Clamp and U-Bolt

Positioning the Clamp: Place the clamp around the pole at the desired height (a).

Securing the U-Bolt: Thread the U-bolt through the clamp and around the pole (b).

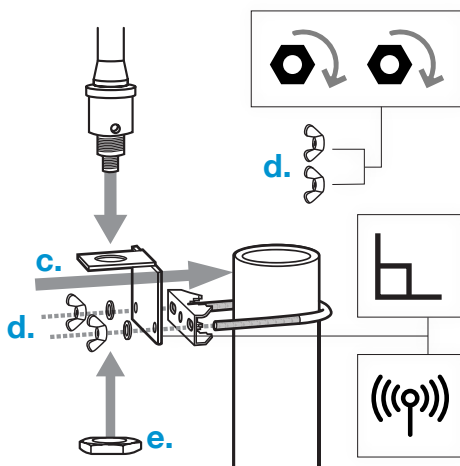

3. Installing the Antenna

Attaching to the Clamp: Align the antenna with the bracket (c), secure the L-bracket with the M6 wing nuts (d), and fix antenna with the M20 nut (e).

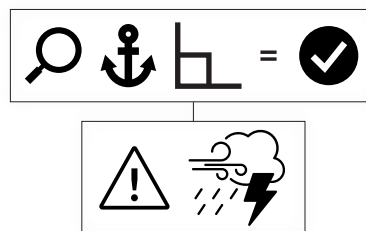

4. Post-Installation Check

Inspection: Confirm the antenna is firmly mounted and aligned correctly.

Maintenance: Periodically inspect for any looseness or corrosion, especially in harsh weather environments.

Positioning: For best results, ensure that the top of the pole does not extend more than 40mm below the L-shaped mount.

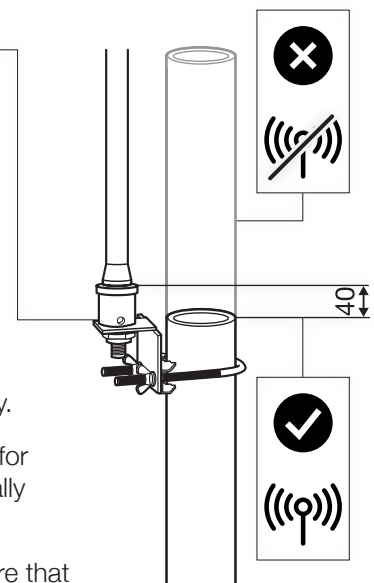

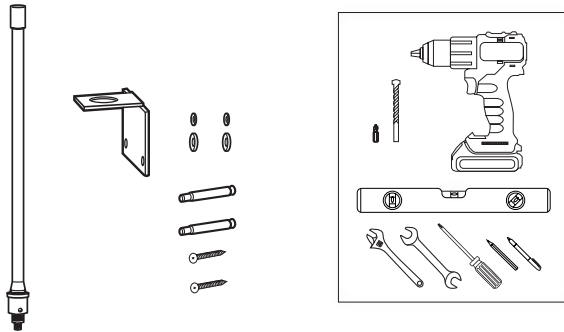

Materials Supplied:

- 1x L-shaped bracket (fitted to the antenna)
- 2x plastic wall anchors
- 2x phillips head screws
- 2x M20 nuts

Required Tools: Drill, 7mm drill bit, 24mm spanner or adjustable wrench, level, phillips head screwdriver or drill bit (PH2), pencil or marker.

1. Choosing the Mounting Surface

Surface Selection: Ensure the chosen wall surface is even and capable of supporting the antenna's weight. Avoid mounting near metallic objects or other antennas to reduce interference.

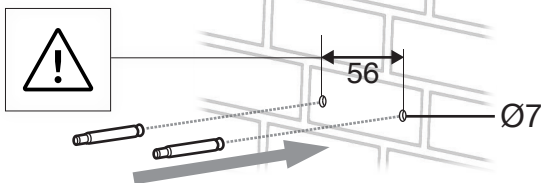

2. Preparing the Surface

Marking Drill Points: Using a level, mark two vertical points 56mm apart where the holes will be drilled.

Drilling: Drill two 7mm diameter holes with a depth of 30 -35mm at the marked points. Be cautious to avoid any internal wiring or piping.

Inserting Frame Anchors:

Place the frame anchors into the drilled holes.

3. Mounting the Antenna

Attaching the Bracket: Align the L-shaped bracket's holes with the frame anchors. Screw in the M20 nut, securing the antenna to the bracket once attached to the wall. Insert the provided screws into the bracket holes and tighten securely.

Final Adjustments: Ensure the antenna is vertical and check for looseness, especially after strong winds and severe weather conditions.

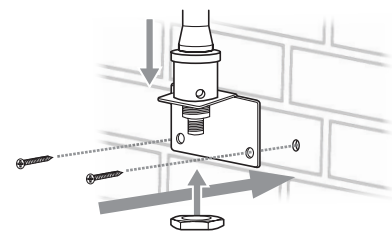

4. Post-Installation Check

Inspection: Verify that the antenna is securely attached and correctly aligned.

Maintenance: Regularly check the antenna for stability and signs of wear, especially after severe weather conditions.

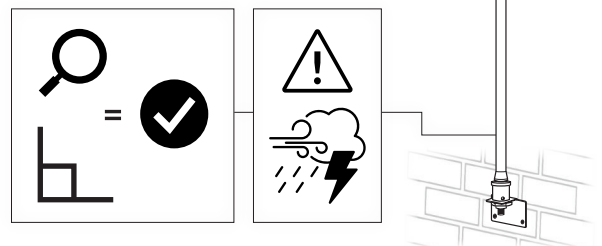

Disclaimers and Waivers

Safety Disclaimer: The installation of this antenna should be carried out in accordance with local safety regulations. The manufacturer is not responsible for damages or injuries resulting from improper installation or use.

Professional Recommendation: For optimal performance and safety, we recommend installation by a qualified professional. Improper installation may void the warranty and could lead to poor performance or safety hazards.

Compliance Statement: Ensure compliance with all local building codes and electrical safety standards. The manufacturer is not liable for any violations of such regulations.

General/Ongoing Maintenance: Regular maintenance checks are essential for sustained performance and safety. Failure to conduct these checks could result in unexpected performance issues and safety risks.

Installation Confirmation: Upon installation, it is the responsibility of the installer to ensure that the antenna is securely mounted and functioning as intended. The manufacturer is not liable for issues arising from installation errors or oversights.